

15" MAX OC IN BETWEEN CORNER SCREWS
3.750" FROM EVERY CORNER

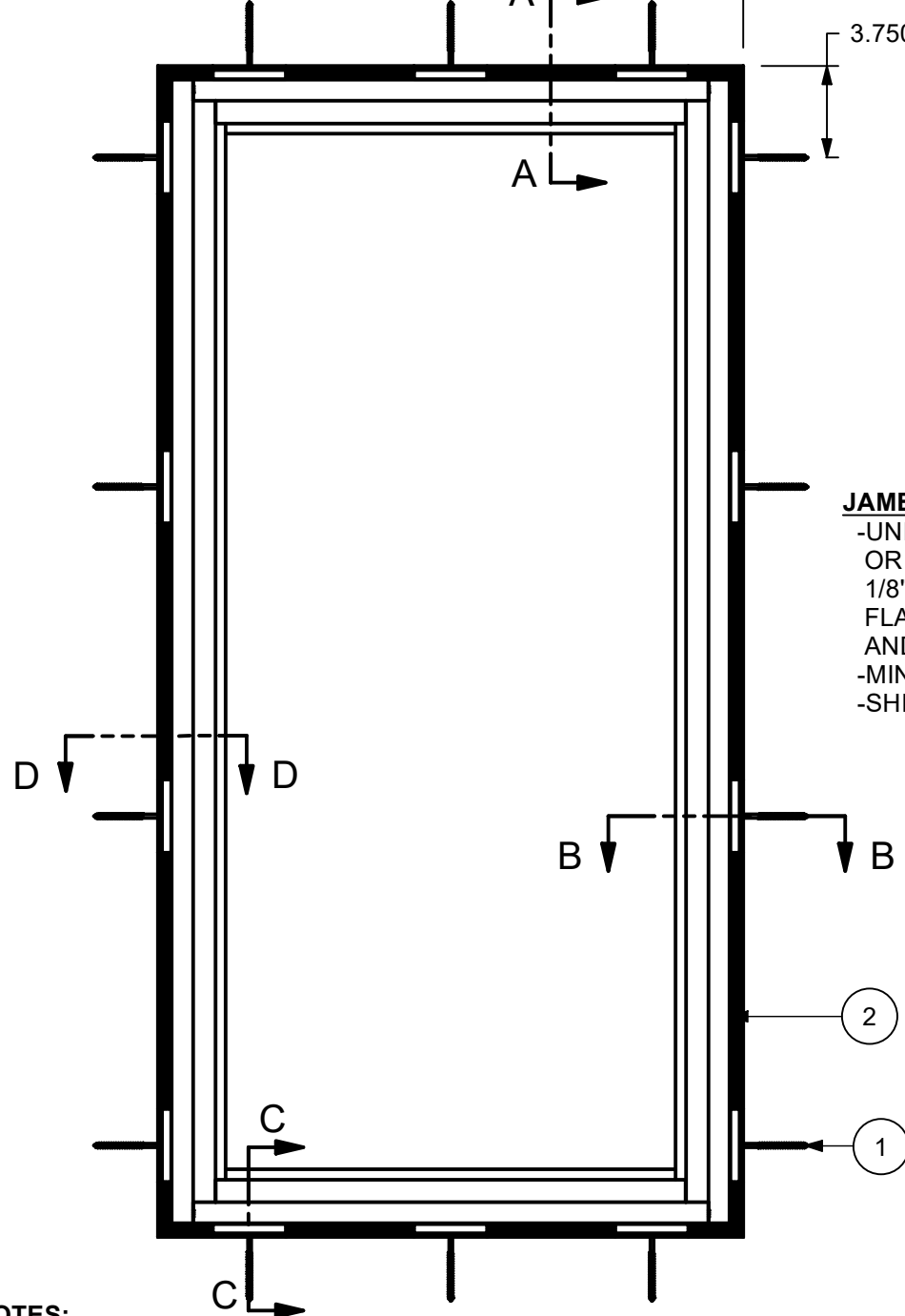

UNIT TYPE	FRAME SIZE	DP RATING
MCAP	74 X 108	+50 / -50
	79 X 102	+50 / -50
	102 X 79	+50 / -50
	96 X 84	+50 / -50
	84 X 96	+50 / -50

MCAP = MODERN CASEMENT PICTURE

JAMB SCREW INSTALLATION METHOD:
 -UNIT MUST NOT BE IN DIRECT CONTACT WITH EITHER CONCRETE OR TREATED BUCK MATERIAL. IF SHIM SPACE IS LESS THAN 1/8" WRAPPING THE UNIT ON ALL 4 SIDES WITH WINDOW FLASHING TAPE IS REQUIRED AS A BARRIER BETWEEN THE UNIT AND CONCRETE OR TREATED LUMBER.
 -MINIMUM OF 2 PER SIDE
 -SHIM AT EACH SCREW LOCATION.

1.250" MIN PENETRATION TYP

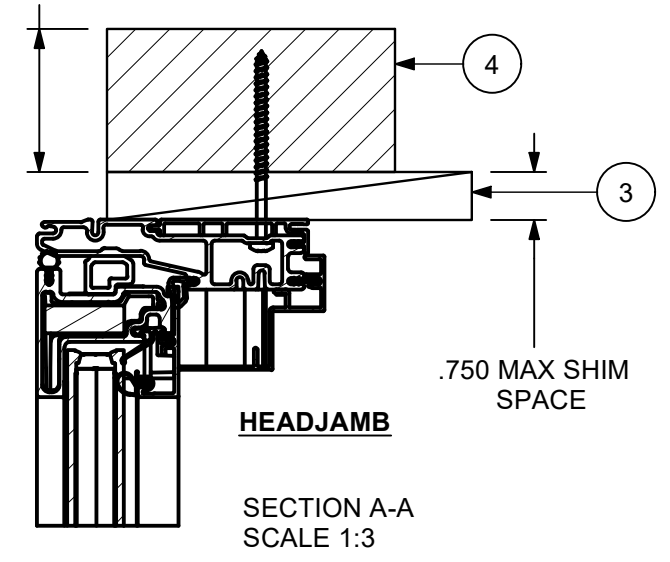

SECTION B-B SCALE 1:3

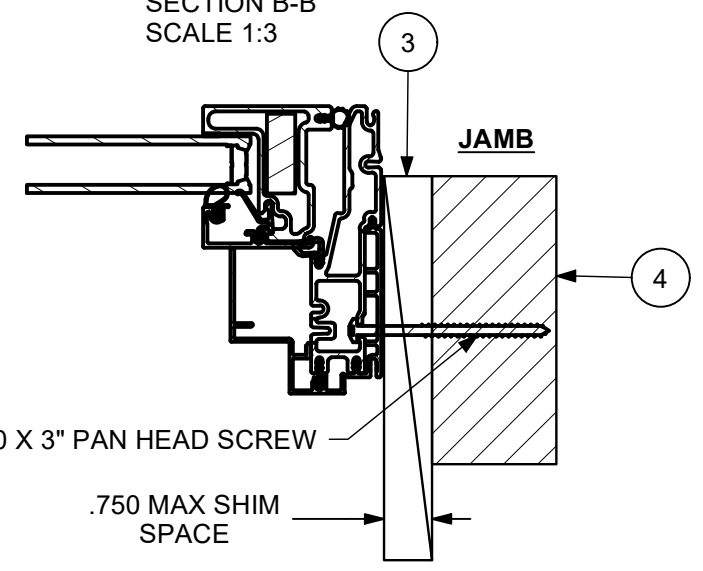

GLAZING VIEW

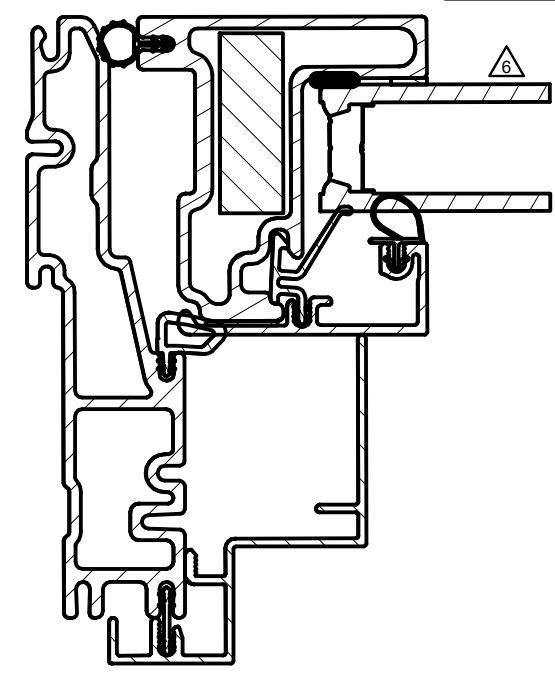

SECTION D-D SCALE 3 : 4

1.125" MIN EDGE DISTANCE TYP

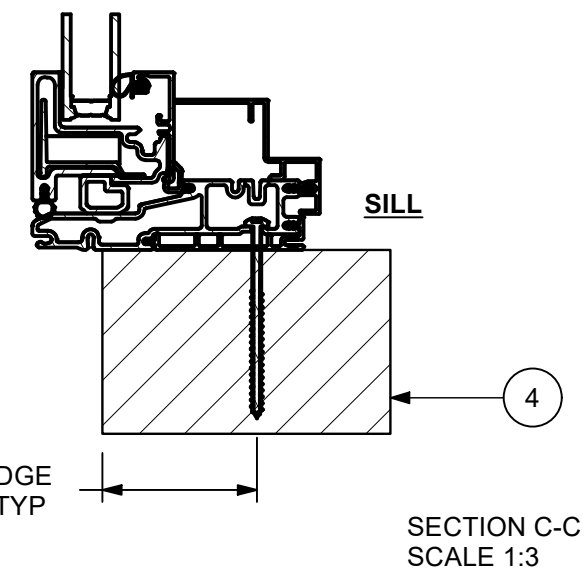

NOTES:

- FOR GENERAL SPECIFICATIONS, REFER TO DOC 00003952
- THIS PRINT IS FOR STUCTURAL PERFORMANCE ONLY. FOR FLASHING & SEALING INSTRUCTIONS, REFER TO THE INSTALLATION INSTRUCTIONS.
- IF CHEMICALLY TREATED LUMBER IS USED FOR BUCK MATERIAL, FASTENERS INTO THE BUCK MUST BE A MINIMUM OF 0.90 OZ/FT^2 ZINC HOT DIPPED GALVANIZED OR STAINLESS STEEL TYPE 304 OR 316
- INSTALLATION SHOWN APPROVED FOR OPERATING AND STATIONARY UNITS
- NAIL FIN FOR ALIGNMENT PURPOSES ONLY, NOT ANCHORED
- GLASS COMPLIES WITH ASTM E1300

ITEM	DWG NO	DESCRIPTION
4	XXXXXXX	FRAMING
3	XXXXXXX	SHIMS
2	00117057	UNIT, PICTURE
1	00111121	#10-12 X 3.000" TORX T25, PH, 2/3 THREAD

MARVIN **RESEARCH & DEVELOPMENT**

COLLECTION: MODERN
DWG TYPE: INSTALLATION
DESCRIPTION: INSTALLATION METHODS

CHK:	SIZE: B	CLASS: ASSY	DWG NO: 00123251
APP:	SCALE: 1/7.5	DATE: 4/14/2020	DWG BY: HOLLERMAN, ROSS
			SHEET: 1 OF 2

REV	DESCRIPTION / REQUESTOR	ECN NO	DATE	REV BY	CATEGORY: CASEMENT	UNIT TYPE: MCAP
0.0	ORIGINAL ISSUE; REMOVED FL NUMBER AND CHANGED DESCRIPTION; ADDED NOTE 6 WITH DELTA; ADDED PARTS LIST; ADDED LABELS TO CROSS SECTIONS	PEND	08/09/23	CAM		